

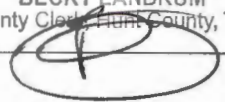

19,260

2000 I-30 E
Greenville, TX 75402

FILED FOR RECORD
at 12:00 o'clock P M
JAN 14 2025
BECKY LANDRUM
County Clerk, Hunt County, Tex.
By 

Tuesday, January 7, 2025

County: Hunt County

Farmers Electric Cooperative Member: SIDNEY TIPPIT
Service Order Number: 2024064460

Greetings:

Farmers Electric Cooperative, Inc. is requesting permission to construct electrical power distribution facilities which will cross County Road 3115 at pole 140481 which is 2325 ft SE of County Road 3119.

Site location map/construction sketches are attached. The construction sketch details the proposed work. The proposed electrical service will be constructed:

- Overhead - All road crossings will have a minimum vertical clearance of 22 feet.
- Underground - All underground bore crossings are PVC encased 4' of coverage from the lowest point of the Right of Way.

If you have any questions, please contact me at any time.

Sincerely,

Psalm Harper
pharper@farmersselectric.coop
Engineering Coordinator

Enclosures

County Approval Section:

Approved: _____ Denied: _____

Authorized Signature: _____ Date: _____



P1 IS 44mi FROM CR 3119

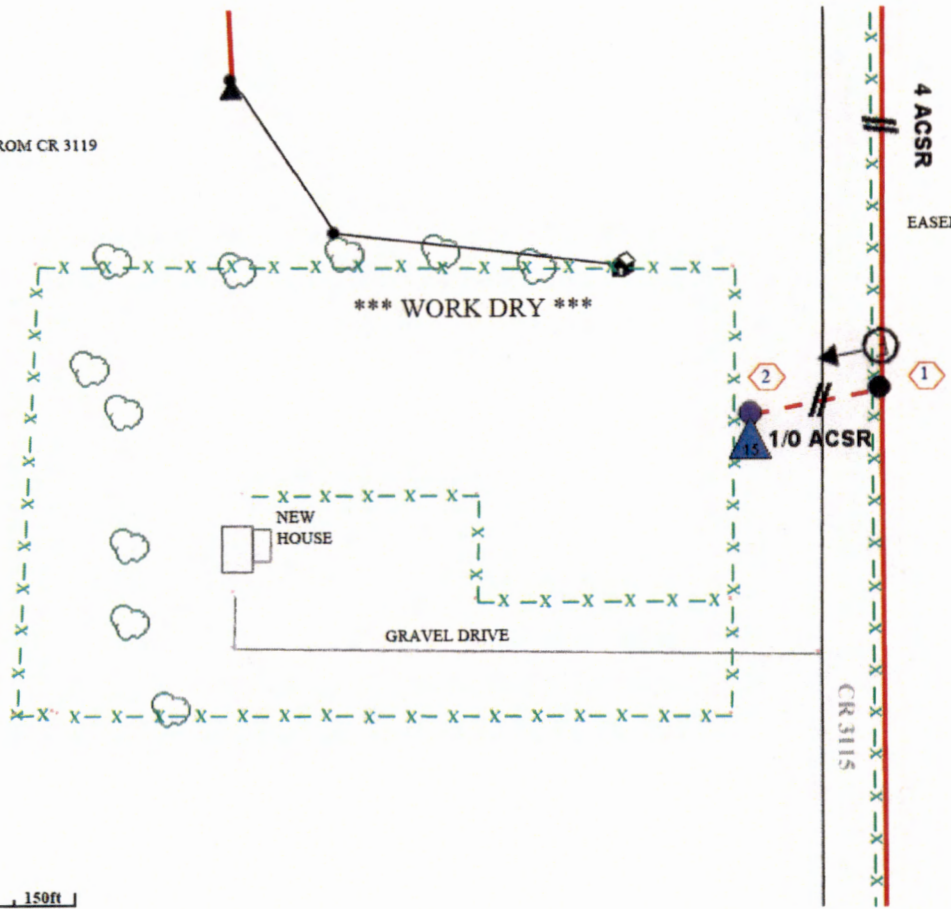

*** WORK DRY ***

NEW HOUSE

GRAVEL DRIVE

CR 3119

4 ACSR

1/0 ACSR

EASEMENT INFO . 30964 & 206972

protective device: OCR 142941

150ft